

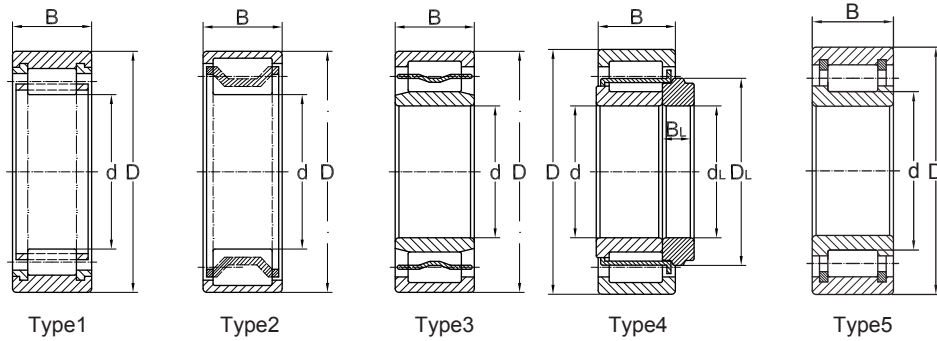

Cylindrical roller bearing



KML No.	Boundary Dimensions (mm)						Mass kg	Type
	d	D	B	dL	DL	BL		
R1559TV	41.201	64.292	21.082				0.291	1
R1563TAV	35.56	57.15	17.78				0.201	1
R1561TV	43.32	75.997	30.353					1
308-203(GRW1111)	35	62.02	18.2					3
A9	35	65	17.1	34.95	50	15.3	0.342	4
A10	39.7	73.050	22.3	39.62	57.1	17.6	0.491	4
A20	39.7	79.992	20.1	39.62	55.5	18.9	0.582	4
JH16283	41.26	64.350	21				0.209	2
JH14070	35.61	57.2	17.8				0.151	2
MU1305TCM	25	61.94	19					5
MU1308UM	40	90	23					5
MUS1307UM	30	80	21					5
MUS1308UM	35	90	23					5
P27-6CG40	27	58	18					5
PL25-7ACG38	25	52	18					5
MUB5204TM	20	47	20.64					5
MUB5205UM	25	52	20.64					5

Repair cylindrical roller bearing

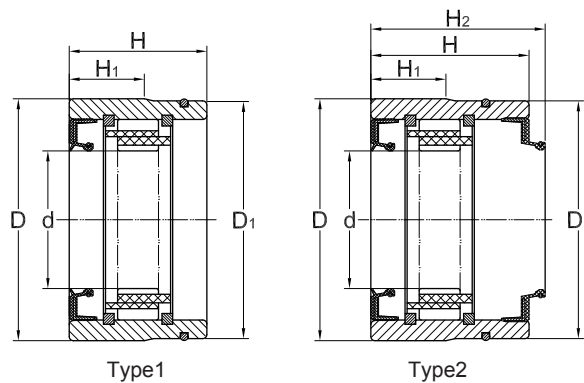

KML No.	Boundary Dimensions (mm)						Type
	d	D	H	D ₁	H ₁	H ₂	
RP1563	35.600	58.287	37.1	57	18.5	46	2
RP1559	41.180	65.438	39.1	64.2	18.5	46	2
RP5707	33.632	58.287	30.76	57	18		1
RP6408	41.250	65.476	33.1	64	18.5		1

Special designed wheel bearings

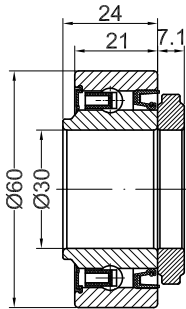

361964
412971

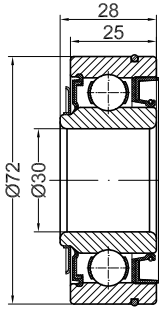

411280

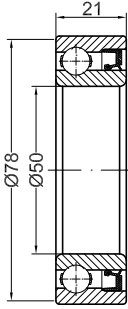

DG5080

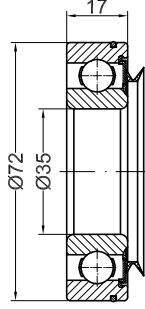

6207EN